

# ARINC 801 TECHNOLOGY

*High Speed Fiber Optics Single and Multimode*



- ▶ **Low loss, low back reflection**
  - ▶ Return loss -50 dB singlemode
  - ▶ Low insertion loss 0.3 dB max mated pair
- ▶ **General use design (no strain relief backshell needed)**
- ▶ **Optical disconnect style available**
- ▶ **PC, UPC or APC ferrule endface**
- ▶ **Genderless design (same contact on both sides of the connector)**
- ▶ **Compatible with multimode and singlemode fiber**
- ▶ **Standard 1.25 mm ferrule and sleeve**
- ▶ **Cable termination identical to LC connector process**
- ▶ **Easy cleaning access to the contact through removable alignment sleeve retainer**
- ▶ **Standard MIL-DTL-38999 and ARINC 600 Size 16 insertion/removal tool**

## SINGLE TERMINUS DESIGN FOR ALL CONNECTOR FORMATS

The ARINC 801 fiber optic terminus is the next generation of butt-joint interconnect technology allowing for higher density multichannel connectors to be achieved. With its standard 1.25 mm ferrule and sleeve, the ARINC 801 terminus is designed for both multimode and singlemode applications and is compatible with standard LC termination processes. The terminus is available both as a pull-proof design and a general use design for tight jacketed cable.

For the pull-proof design, the cable jacket is crimped on an external body and a floating mechanism avoids any loss of performance when pulling on the cable. This feature allows for the use of the connector without a backshell.

Standard connector formats include MIL-DTL-38999 type, MIL-DTL-83527 type, ARINC 600 and ARINC 781.

# SIZE 16 ARINC 801 TERMINUS

## Specifications & Insert Arrangements

### ▶ SIZE 16 ARINC 801 CONTACT



PART NUMBER	MODE	STYLE	POLISH
238500-8000	Multi	Pull Proof Loose Jacket	PC
238500-8001	Multi	Tight Jacket	PC
238500-8002	Single	Pull Proof Loose Jacket	PC
238500-8003	Single	Pull Proof Loose Jacket	APC
238500-8004	Single	Tight Jacket	PC
238500-8005	Single	Tight Jacket	APC

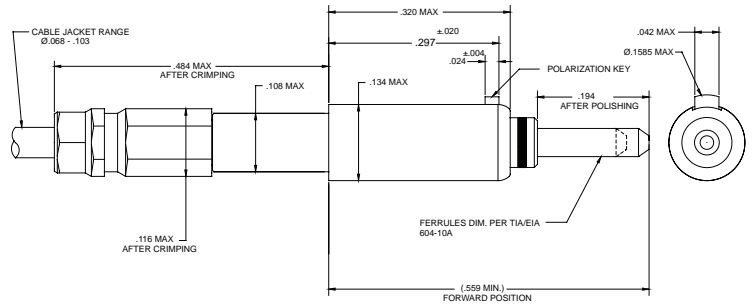

### ▶ ARINC 600 INSERT ARRANGEMENTS

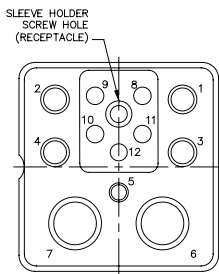

12F5C2

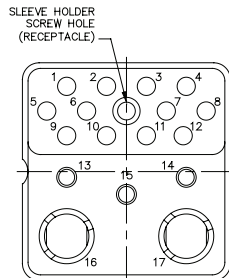

17F12Q2

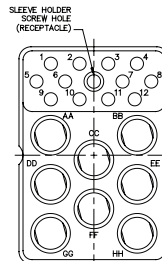

20F12T8/20F12Q8

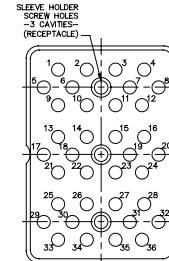

36F36

QTY	SIZE	CONTACT	CAVITY I.D.
4	12	Electrical	1 to 4
1	16	Electrical	5
2	5	Quadrax	6 to 7
5	16	Optical Termini	8 to 12

QTY	SIZE	CONTACT	CAVITY I.D.
12	16	Optical Termini	1 to 12
3	16	Electrical	13 to 15
2	8	Quadrax	16 to 17

QTY	SIZE	CONTACT	CAVITY I.D.
12	16	Optical Termini	1 to 12
8	8	Twinax/Quadrax	AA to HH

QTY	SIZE	CONTACT	CAVITY I.D.
36	16	Optical Termini	1 to 36

### ▶ MIL-DTL-38999 INSERT ARRANGEMENTS



SIZE 11  
11-02



SIZE 13  
13-04

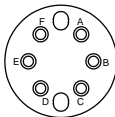

SIZE 15  
15-06

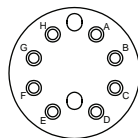

SIZE 17  
17-08

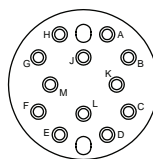

SIZE 19  
19-12

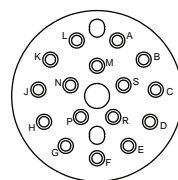

SIZE 21  
21-16

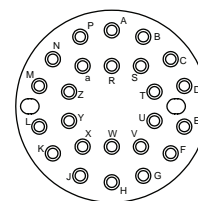

SIZE 23  
23-24

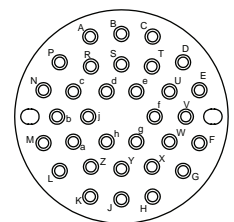

SIZE 25  
25-32

# CONNECTOR SHELLS

## Specifications & Dimensions

### ► MIL-DTL-38999 PLUG

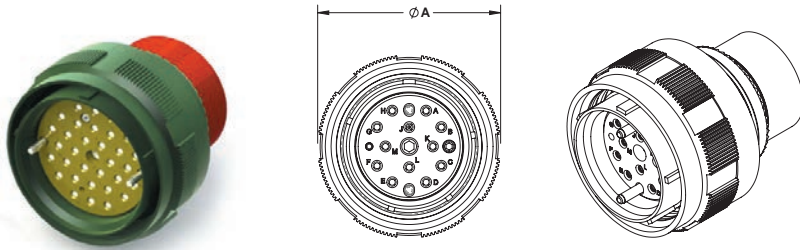

PART NUMBER* Olive Drab Cadmium	PART NUMBER* Electroless Nickel	POLARIZATION	SIZE	CONTACTS	INSERT	A MAX (inches)
<a href="#">236400-2064-X</a>	<a href="#">236400-2030-X</a>	N, A, B, C, D, E	11	2	11-02	0.984
<a href="#">236400-2047-X</a>	<a href="#">236400-2000-X</a>	N, A, B, C, D, E	13	4	13-04	1.157
<a href="#">236400-2033-X</a>	<a href="#">236400-2008-X</a>	N, A, B, C, D, E	15	6	15-06	1.280
<a href="#">236400-2017-X</a>	<a href="#">236400-2046-X</a>	N, A, B, C, D, E	17	8	17-08	1.406
<a href="#">236400-2048-X</a>	<a href="#">236400-2018-X</a>	N, A, B, C, D, E	19	12	19-12	1.516
<a href="#">236400-2062-X</a>	<a href="#">236400-2031-X</a>	N, A, B, C, D, E	21	16	21-16	1.642
<a href="#">236400-2049-X</a>	<a href="#">236400-2045-X</a>	N, A, B, C, D, E	23	24	23-24	1.768
<a href="#">236400-2063-X</a>	<a href="#">236400-2035-X</a>	N, A, B, C, D, E	25	32	25-32	1.890

\*-X denotes polarization. Ex: 236400-2064-C for Plug, Size 11, O.D. Cadmium Plated, C Polarization

### ► MIL-DTL-38999 FLANGE MOUNT RECEPTACLE

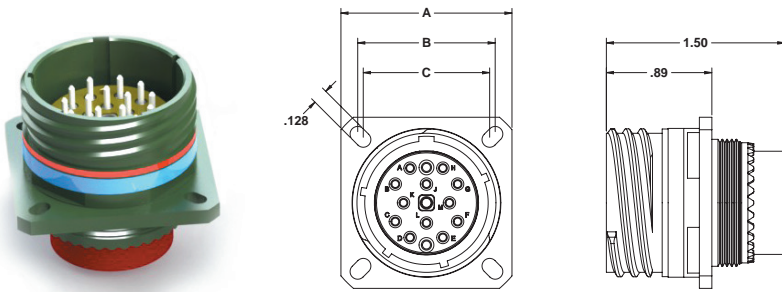

#### PANEL CUTOUTS

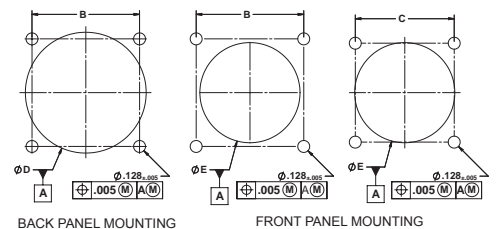

PART NUMBER* Olive Drab Cadmium	PART NUMBER* Electroless Nickel	POLARIZATION	SIZE	CONTACTS	INSERT	A (inches)	B (inches)	C (inches)	D MIN (inches)	E MIN (inches)
<a href="#">236400-3062-X</a>	<a href="#">236400-3049-X</a>	N, A, B, C, D, E	11	2	11-02	1.031	0.812	0.719	0.796	0.625
<a href="#">236400-3063-X</a>	<a href="#">236400-3000-X</a>	N, A, B, C, D, E	13	4	13-04	1.126	0.906	0.812	0.922	0.750
<a href="#">236400-3038-X</a>	<a href="#">236400-3013-X</a>	N, A, B, C, D, E	15	6	15-06	1.220	0.969	0.906	1.047	0.906
<a href="#">236400-3064-X</a>	<a href="#">236400-3052-X</a>	N, A, B, C, D, E	17	8	17-08	1.311	1.062	0.969	1.219	1.016
<a href="#">236400-3079-X</a>	<a href="#">236400-3022-X</a>	N, A, B, C, D, E	19	12	19-12	1.437	1.156	1.062	1.297	1.141
<a href="#">236400-3080-X</a>	<a href="#">236400-3026-X</a>	N, A, B, C, D, E	21	16	21-16	1.563	1.250	1.156	1.422	1.266
<a href="#">236400-3066-X</a>	<a href="#">236400-3023-X</a>	N, A, B, C, D, E	23	24	23-24	1.689	1.375	1.250	1.547	1.375
<a href="#">236400-3067-X</a>	<a href="#">236400-3053-X</a>	N, A, B, C, D, E	25	32	25-32	1.811	1.500	1.375	1.672	1.484

\*-X denotes polarization. Ex: 236400-3062-N for Flange Mount Receptacle, Size 11, O.D. Cadmium Plated, N Polarization

► MIL-DTL-38999 JAM NUT RECEPTACLE

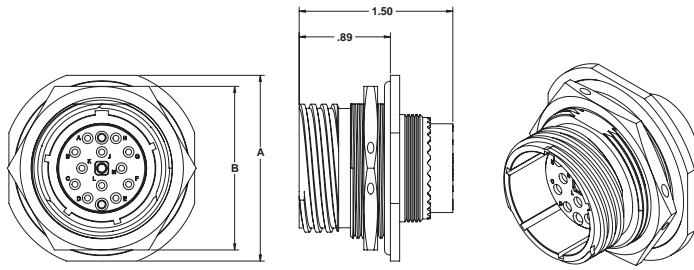

PANEL CUTOUTS

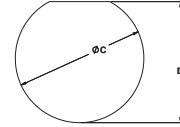

PART NUMBER* Olive Drab Cadmium	PART NUMBER* Electroless Nickel	POLARIZATION	SIZE	CONTACTS	INSERT	A (inches)	B MAX (inches)	C (+0.01 -0.00) (inches)	D MIN (+0.00 -0.003) (inches)
236400-3081-X	236400-3025-X	N, A, B, C, D, E	11	2	11-02	1.031	0.812	0.719	0.796
236400-3082-X	236400-3032-X	N, A, B, C, D, E	13	4	13-04	1.126	0.906	0.812	0.922
236400-3083-X	236400-3051-X	N, A, B, C, D, E	15	6	15-06	1.220	0.969	0.906	1.047
236400-3084-X	236400-3011-X	N, A, B, C, D, E	17	8	17-08	1.311	1.062	0.969	1.219
236400-3065-X	236400-3034-X	N, A, B, C, D, E	19	12	19-12	1.437	1.156	1.062	1.297
236400-3085-X	236400-3006-X	N, A, B, C, D, E	21	16	21-16	1.563	1.250	1.156	1.422
236400-3086-X	236400-3037-X	N, A, B, C, D, E	23	24	23-24	1.689	1.375	1.250	1.547
236400-3087-X	236400-3040-X	N, A, B, C, D, E	25	32	25-32	1.811	1.500	1.375	1.672

\*-X denotes polarization. Ex: 236400-3081-N for Jam Nut Receptacle, Size 11, O.D. Cadmium Plated, N Polarization

► ARINC 600 SHELL SIZE 2

Please consult factory for ordering information

